

# SERVICE VALVE

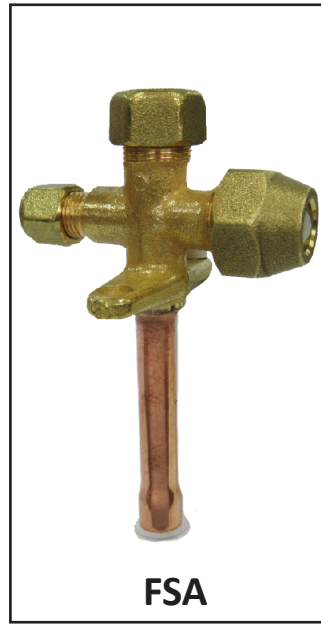

## Dimension : mm

Part No.	Description	A	B	Connection	C	D	E	F	G	H	I	J	K	L
PV22 FS	Packed Valve 1/4 two ways	60	-	6.35 (1/4")	7/16-20 UNF	27	6.43	17.65	39	4	19	38	17	14
PV22 FSA	Packed Valve 1/4	60	29											
PV22 FSA/S	Packed Valve 1/4 short pipe	30												
PV33 FS	Packed Valve 3/8 two ways	60	-	9.53 (3/8")	5/8-18 UNF	27	9.6	17.65	39	4	19	38	22	14
PV33 FSA	Packed Valve 3/8	60	29											
PV33 FSA/S	Packed Valve 3/8 short pipe	30												
PV44 FSA	Packed Valve 1/2	60	30	12.7 (1/2")	3/4-16 UNF	33.5	12.8	17	50	5	27	38	24	14
PV44 FSA/S	Packed Valve 1/2 short pipe	30												
PV55 FSA	Packed Valve 5/8	60	30	15.88 (5/8")	7/8-14 UNF	36.75	160.2	20.2	56	5	30	38	27	14
PV55 FSA/S	Packed Valve 5/8 short pipe	30												
PV66 FSA	Packed Valve 3/4	60	34	19.05 (3/4")	1 1/16"-14 UNS	44.25	19.18	26	65	6	35	44	32	14
PV66 FSA/S	Packed Valve 3/4 short pipe	30												
PV77 FSA	Packed Valve 7/8	60	35	22.22 (7/8")	1 1/4"-12 UNF	46.50	22.4	30	75	8	36	50	35	14
PV77 FSA/S	Packed Valve 7/8 short pipe	30												

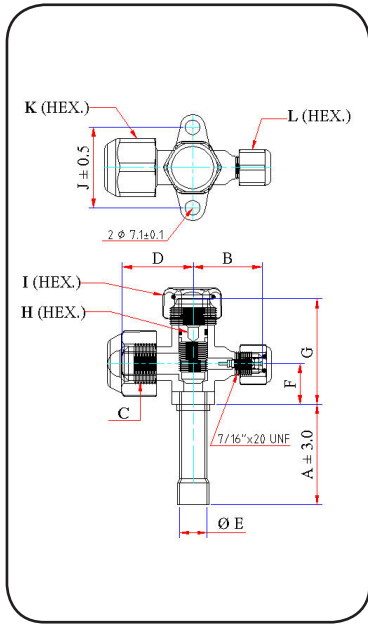
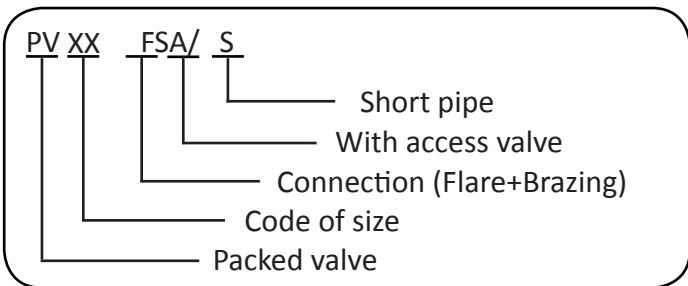

### Specification

1. For freon R12, R22, R502, R134a, R407C
2. Maximum working pressure 30 g/SQ CM., gauge(430 Psig.)
3. Operating temperature range: -28 °C to 100 °C



### GRAND D.K. CO., LTD.

1/17 Moo 2, Rama 2 Road, Thasai, Muong Samutsakhon74000, Thailand.  
Tel. (662) 8080457, 8080458 Fax. (662) 8081217, 8081218

Email: [grand@loxinfo.co.th](mailto:grand@loxinfo.co.th)

[www.packedvalve.com](http://www.packedvalve.com), [www.servicevalve.com](http://www.servicevalve.com), [www.servicevalve.net](http://www.servicevalve.net)

MANUFACTURER

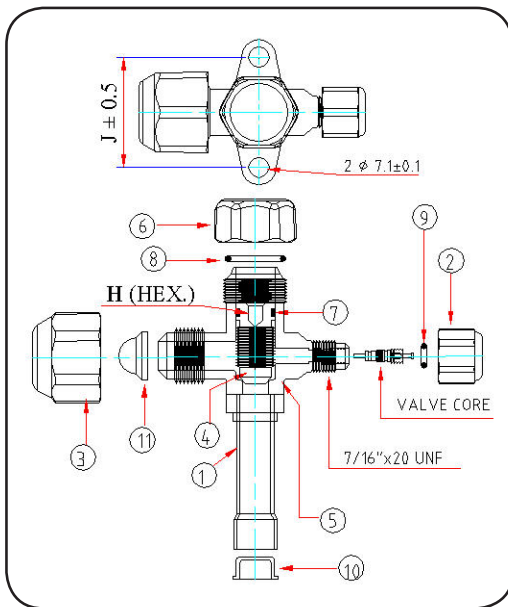

No.	Description	Material
1	Tube connection	Copper
2	Cap, charging port	Brass (C3601)
3	Forged flare nut	Brass (C3601)
4	Plunger	Brass (C3601)
5	Body(forged)	Brass (C3607)
6	Cap, valve port	Brass (C3601)
7	O - ring	Neoprene
8	O - ring	Neoprene
9	O - ring	Neoprene
10	Tube seal	LDPE
11	Flare seal bonnet	Nylon-6

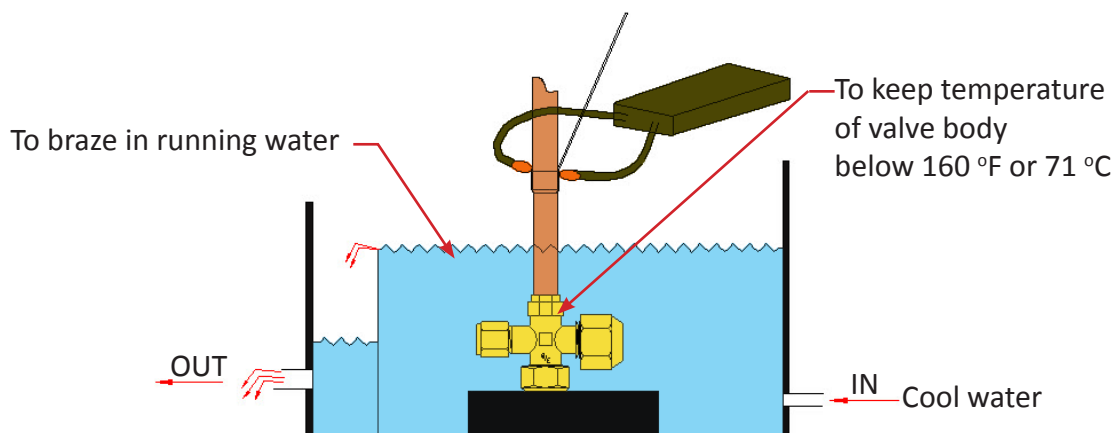

**Brazing Intruction**

### Engineering Specification Data

Description service valve	
<b>Construction</b>	<ul style="list-style-type: none"> <li>• Body(5) : Forged Brass (C3771)</li> <li>• Plunger(4) : Brass with O-ring tightening torque for seating: Size 1/4, 3/8 = 2.5 - 3.0 ft-lb. (3.4 - 4.0 N-m) Size 1/2, 5/8 = 10 - 12.5 ft-lb. (13 - 17 N-m) Size 3/4, 7/8 = 20 - 25 ft-lb. (27 - 34 N-m)</li> <li>• Seat : Metal contact seat</li> <li>• Service Port : 1/4 Sae – Flare with valve-core, Tightening torque for valve-core = 1.5-3.0 In-lb. (0.17-0.34 N-m)</li> <li>• Weld : By silver brazing, to withstand to 1100 deg.F (600 deg.C.)</li> </ul>
<b>Static Pressure</b>	• Maximum working pressure 430 Psig.(30kg./Sqcm. Gauge)
<b>Working Temperature</b>	• -28 °C To 100 °C (-20 °F To 212 °F)
<b>Refrigerant</b>	• R12, R22, R502, R134a, R407c
<b>Leak Test</b>	• 100% Leak test of valve functions (open and close) by bubble leak test with nitrogen at 450 Psig.(31kg./Sqcm. Gauge)



**GRAND D.K. CO., LTD.**

1/17 Moo 2, Rama 2 Road, Thasai, Muong Samutsakhon 74000, Thailand.  
Tel. (662) 8080457, 8080458 Fax. (662) 8081217, 8081218

Email: [grand@loxinfo.co.th](mailto:grand@loxinfo.co.th)

[www.packedvalve.com](http://www.packedvalve.com), [www.servicevalve.com](http://www.servicevalve.com), [www.servicevalve.net](http://www.servicevalve.net)

MANUFACTURER